

Drop-in Isolators

Part Number: KTDI302C-100

Main Features:

- Broad Option of Frequency Range: 3GHz - 6GHz
- Small Size, High Isolation, Low Insertion Loss, High Power Handling
- Wide Operating Temperature: -30°C~+70°C
- Commercial, Military and Space Applications

Electrical Specifications at Room Temperature:

| Part Number | Freq. Range (GHz) | Bandwidth Max. (MHz) | Insertion Loss Max. (dB) | Isolation Min. (dB) | VSWR Max. | Reverse Power | Connector Type |
|--------------|-------------------|----------------------|--------------------------|---------------------|-----------|---------------|----------------|
| KTDI302C-100 | 3 - 6 | 300 | 0.3 | 23 | 1.20 | 100 | TAB |
| KTDI302C-100 | 3 - 6 | 600 | 0.5 | 20 | 1.20 | 100 | TAB |

Mechanical Dimensions (mm):

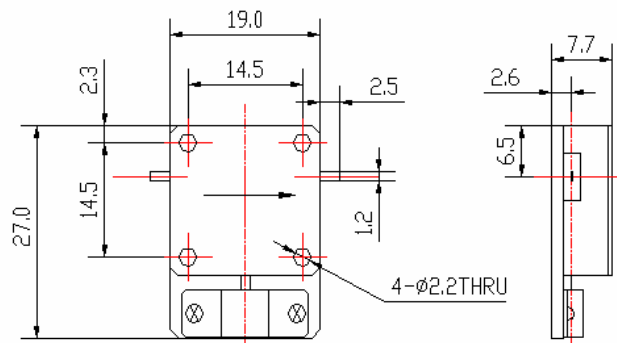

HOW TO ORDER

