

Waveguide High Power Circulators

Part Number: KTWC320-25.4B1

Main Features:

- Broad Frequency Range: 26.4GHz - 40.1GHz
- High Power Handling, High Isolation, Low Insertion Loss
- Wide Temperature Range: -40°C~+85°C
- Commercial, Military and Space Applications

Electrical Specifications at Room Temperature:

| Part Number | Freq. Range (GHz) | Relative Bandwidth | Insertion Loss Max. (dB) | Isolation Min. (dB) | VSWR Max. | Peak Power (W) | Duty Ratio | Waveguide Type |
|----------------|-------------------|--------------------|--------------------------|---------------------|-----------|----------------|------------|----------------|
| KTWC320-25.4B1 | 26.4 - 40.1 | 3% | 0.3 | 20 | 1.20 | 500 | 10% | WR28 |

Mechanical Dimensions (mm):

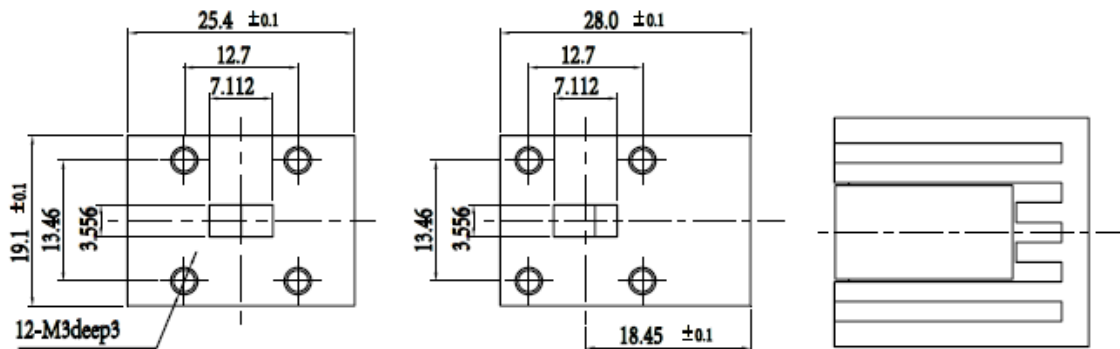

HOW TO ORDER

