

## Dual Junction Coaxial Circulators

Part Number: KTCC-101AS

### Main Features:

- Dual Junction, Frequency Range: 1.2GHz - 2.5GHz
- Small Size, High Isolation, Low Insertion Loss, High Power Handling
- Wide Operating Temperature: -40°C~+85°C
- Commercial, Military and Space Applications

### Electrical Specifications at Room Temperature:

Part Number	Freq. Range (GHz)	Bandwidth Max. (MHz)	Insertion Loss Max. (dB)	Isolation Min. (dB)	VSWR Max.	Average Power (W)	Connector Type
KTCC-101AS	1.2 - 2.5	200	0.6	46	1.20	100	SMA/N

### Mechanical Dimensions (mm):

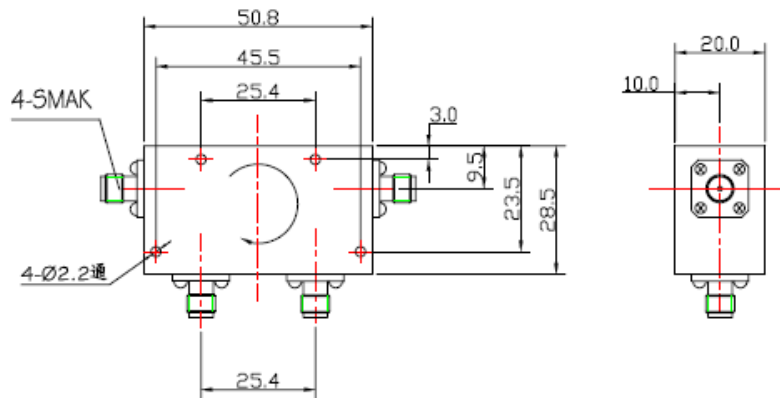

### HOW TO ORDER

