

Coaxial Circulators

Part Number: KTCC-0401A

Main Features:

- Frequency Range: 0.4GHz - 0.6GHz
- Small Size, High Isolation, Low Insertion Loss, High Power Handling
- Wide Operating Temperature: -15°C~+60°C
- Commercial, Military and Space Applications

Electrical Specifications at Room Temperature:

Part Number	Freq. Range (GHz)	Bandwidth Max. (MHz)	Insertion Loss Max. (dB)	Isolation Min. (dB)	VSWR Max.	Average Power (W)	Connector Type
KTCC-0401A	0.4 - 0.6	50	0.4	20	1.25	150	SMA/N

Mechanical Dimensions (mm):

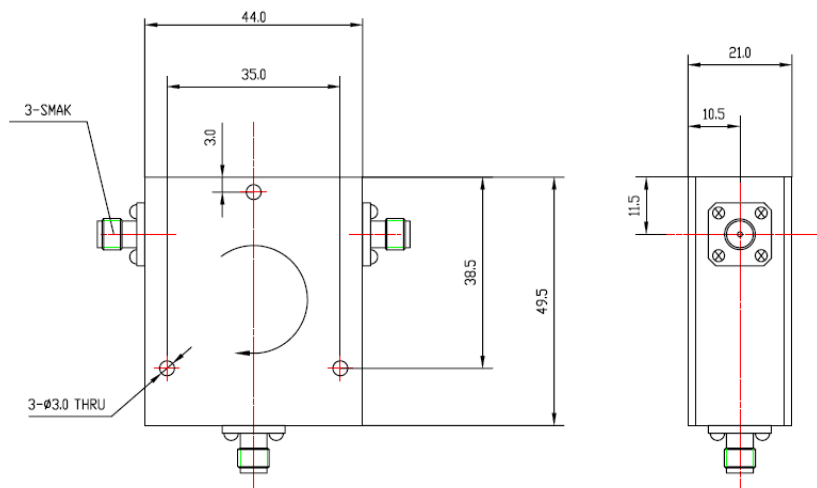

HOW TO ORDER

