

## Waveguide Isolators

Part Number: KTWI500-10

### Main Features:

- Broad Frequency Range: 39.3GHz - 59.7GHz
- High Isolation, Low Insertion Loss, Small Size
- Wide Operating Temperature: -40°C~+85°C
- Commercial, Military and Space Applications

### Electrical Specifications at Room Temperature:

Part Number	Freq. Range (GHz)	Bandwidth Max. (MHz)	Insertion Loss Max. (dB)	Isolation Min. (dB)	VSWR Max.	Waveguide Type
KTWI500-10	39.3 - 59.7	1000	0.3	23	1.20	WR18
KTWI500-10	39.3 - 59.7	2000	0.4	20	1.25	WR18

### Mechanical Dimensions (mm):

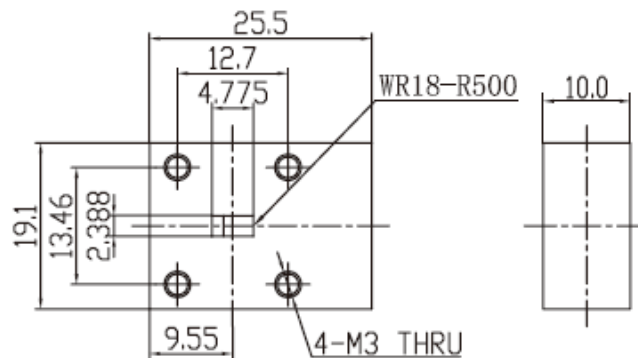

### HOW TO ORDER

