

## Waveguide Circulators

Part Number: KTWC70-68.3

### Main Features:

- Broad Frequency Range: 5.38GHz - 8.18GHz
- High Isolation, Low Insertion Loss, Small Size
- Wide Temperature Range: -40°C ~ +85°C
- Commercial, Military and Space Applications

### Electrical Specifications at Room Temperature:

Part Number	Freq. Range (GHz)	Bandwidth Max. (MHz)	Insertion Loss Max. (dB)	Isolation Min. (dB)	VSWR Max.	Waveguide Type
KTWC70-68.3	5.38 - 8.18	500	0.3	23	1.20	WR137
KTWC70-68.3	5.38 - 8.18	1000	0.4	20	1.25	WR137

### Mechanical Dimensions (mm):

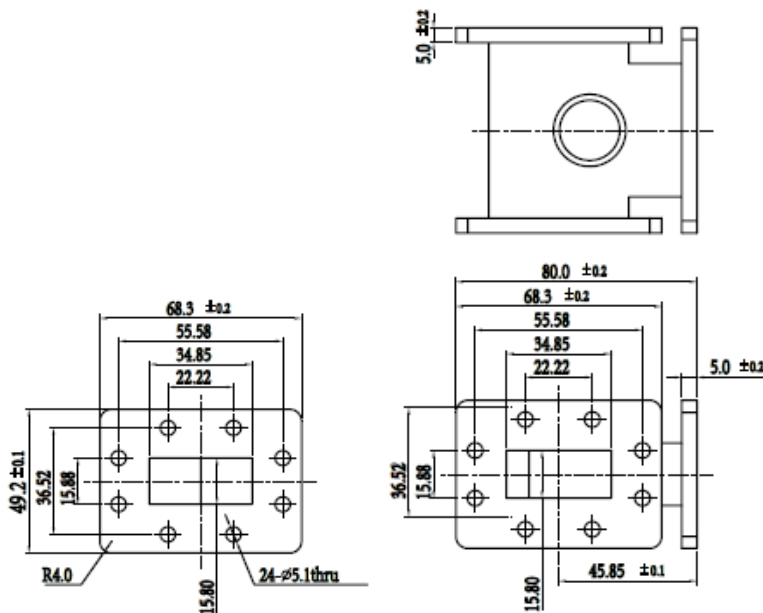

### HOW TO ORDER

