

## Waveguide Circulators

Part Number: KTWC100-48

### Main Features:

- Broad Frequency Range: 8.2GHz -12.5GHz
- High Isolation, Low Insertion Loss, Small Size
- Wide Operating Temperature: -40°C~+85°C
- Commercial, Military and Space Applications

### Electrical Specifications at Room Temperature:

Part Number	Freq. Range (GHz)	Bandwidth Max. (MHz)	Insertion Loss Max. (dB)	Isolation Min. (dB)	VSWR Max.	Waveguide Type
KTWC100-48	8.2 - 12.5	1000	0.3	23	1.20	WR90
KTWC100-48	8.2 - 12.5	2000	0.4	20	1.25	WR90

### Mechanical Dimension (mm):

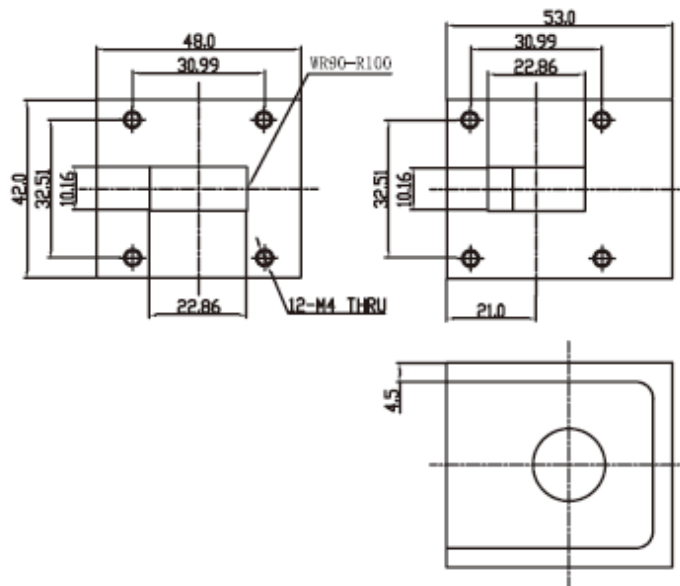

### HOW TO ORDER

