

## Waveguide Circulators

Part Number: KTWC120-42

### Main Features:

- Broad Frequency Range: 9.48GHz - 15.0GHz
- High Isolation, Low Insertion Loss, Small Size
- Wide Operating Temperature: -40°C~+85°C
- Commercial, Military and Space Applications

### Electrical Specifications at Room Temperature:

Part Number	Freq. Range (GHz)	Bandwidth Max. (MHz)	Insertion Loss Max. (dB)	Isolation Min. (dB)	VSWR Max.	Waveguide Type
KTWC120-42	9.48 - 15.0	1000	0.3	23	1.20	WR75
KTWC120-42	9.48 - 15.0	2000	0.4	20	1.25	WR75

### Mechanical Dimensions (mm):

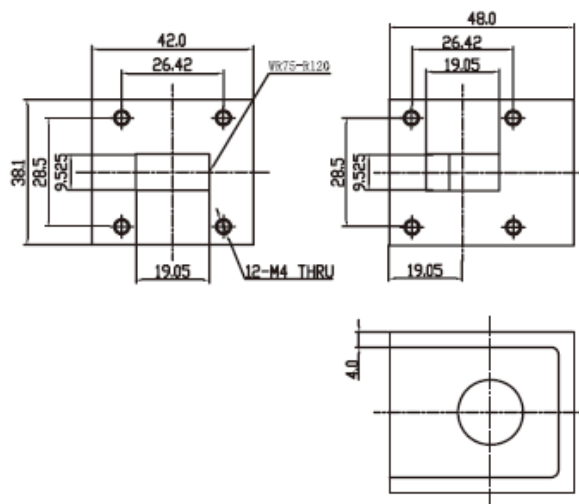

### HOW TO ORDER

