

Waveguide Circulators

Part Number: KTWC900-10A

Main Features:

- Broad Frequency Range: 73.8GHz - 112GHz
- High Isolation, Low Insertion Loss, Small Size
- Wide Temperature Range: - 40°C~+85°C
- Commercial, Military and Space Applications

Electrical Specifications at Room Temperature:

Part Number	Freq. Range (GHz)	Bandwidth Max. (MHz)	Insertion Loss Max. (dB)	Isolation Min. (dB)	VSWR Max.	Waveguide Type
KTWC900-10A	73.8 - 112	1000	0.8	20	1.25	WR10
KTWC900-10A	73.8 - 112	2000	1.0	18	1.30	WR10

Mechanical Dimensions (mm):

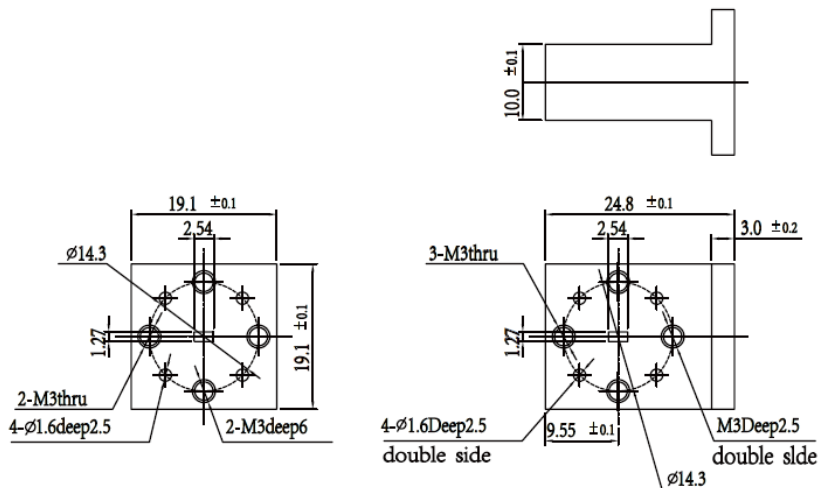

HOW TO ORDER

