

Waveguide Circulators

Part Number: KTWC740-25.4

Main Features:

- Broad Frequency Range: 60.5GHz - 92.0GHz
- High Isolation, Low Insertion Loss ,Small Size
- Wide Temperature Range: - 40℃~+85℃
- Commercial, Military and Space Applications

Electrical Specifications at Room Temperature:

Part Number	Freq. Range (GHz)	Bandwidth Max. (MHz)	Insertion Loss Max. (dB)	Isolation Min. (dB)	VSWR Max.	Waveguide Type
KTWC740-25.4	60.5 - 92.0	1000	0.8	18	1.30	WR12

Mechanical Dimensions (mm):

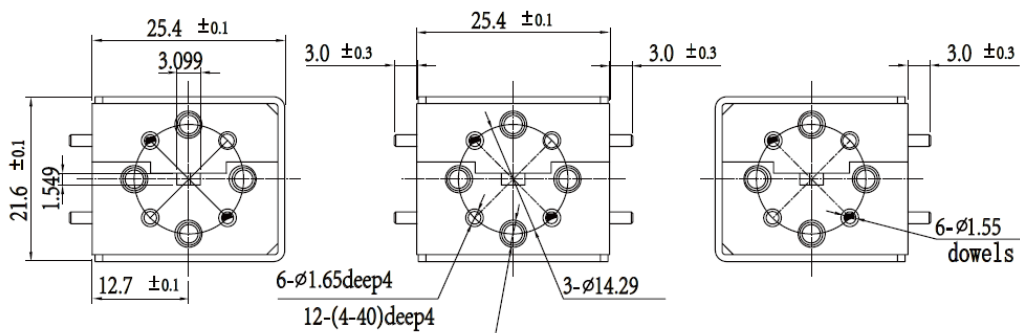

HOW TO ORDER

