

Solder-in Type Feed-through Capacitors (EMI Filters)

Key Features

- ✧ Voltage Rating to 750VDC
- ✧ Multiple Circuit Configurations: C, LC & Pi available
- ✧ High Temperature Construction to Prevent Reflow during Installation
- ✧ Customize Design is available
- ✧ RoHS Compliant

HOW TO ORDER

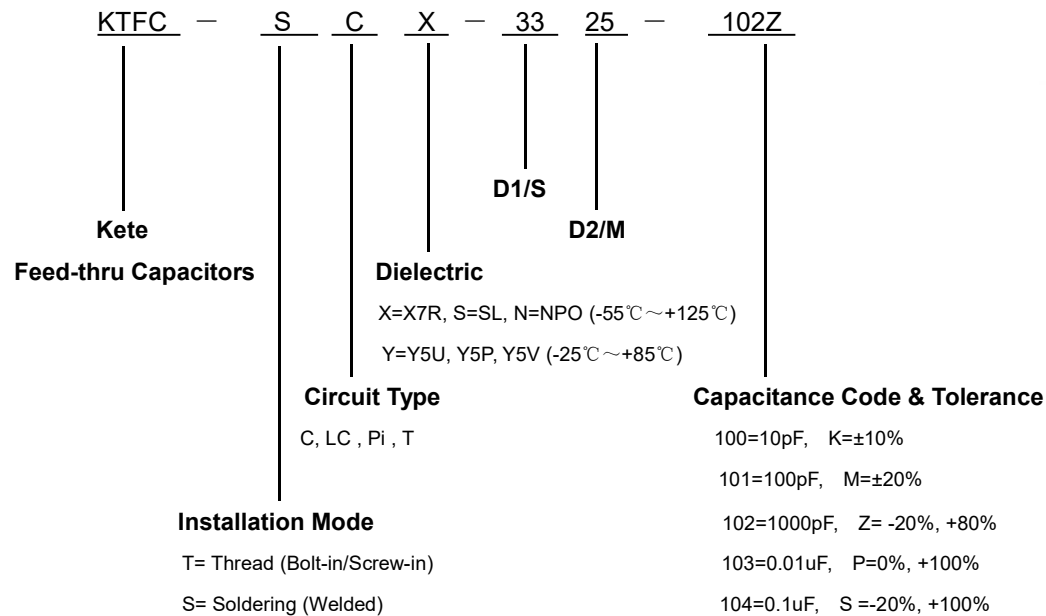

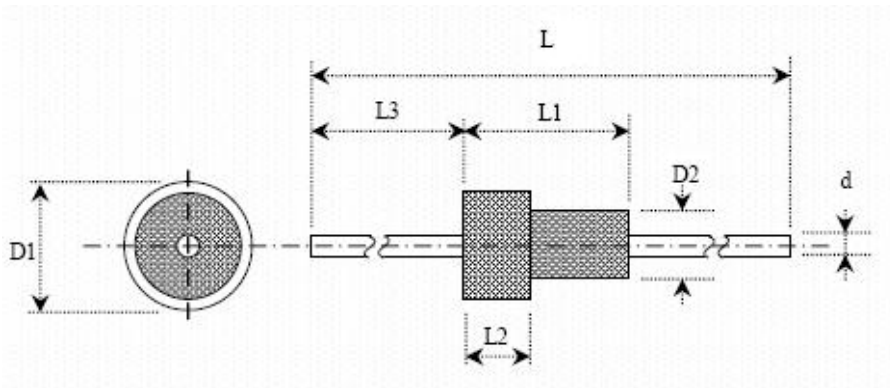

Here just list out part of catalogs as follows for reference. Customized products are available, please consult with Kete.

| Solder-in Type Series Number | Outline Dimensions (mm) | | | | | | | Dielectric Code | Capacitance | Tolerance | Rated Voltage | Withstand Voltage | Current | Circuit |
|---------------------------------|-------------------------|-----|------|------|-----|-----|------|--------------------|-------------|------------------|------------------|----------------------|---------|---------|
| | D1 | D2 | d | L | L1 | L2 | L3 | | | | | | | |
| KTFC-SCS1717-101M | 1.7 | 1.7 | 0.5 | 14.5 | 2.7 | 0 | 5.5 | SL | 100pF | M ($\pm 20\%$) | 100VDC | 300VDC | 5A | C |
| KTFC-SCS1717-101M | 1.7 | 1.7 | 1 | 28.3 | 2.7 | 0 | 13.5 | SL | 100pF | M ($\pm 20\%$) | 100VDC | 300VDC | 10A | C |
| KTFC-SCX1915-102Z | 1.9 | 1.5 | 0.75 | 8.7 | 3 | 1 | 3 | X7R | 1000pF | Z (-20%, +80%) | 100VDC | 300VDC | 7A | C |
| KTFC-SCX1915B-102Z | 1.9 | 1.5 | 0.75 | 22 | 3.5 | 1 | 10 | X7R | 1000pF | Z (-20%, +80%) | 100VDC | 300VDC | 7A | C |
| KTFC-SCX1915-102P | 1.9 | 1.5 | 0.75 | 28.3 | 3.5 | 1 | 10 | X7R | 1000pF | P (-0%~, +100%) | 100VDC | 300VDC | 7A | C |
| KTFC-SCN1915-100Z | 1.9 | 1.5 | 0.7 | 24 | 3.5 | 1 | 10 | NPO | 10pF | Z (-20%, +80%) | 100VDC | 300VDC | 7A | C |
| KTFC-SCN1915-100Z | 1.9 | 1.5 | 0.5 | 14.5 | 2 | 0.5 | 5.5 | NPO | 10pF | Z (-20%, +80%) | 100VDC | 300VDC | 7A | C |

| | | | | | | | | | | | | | | |
|------------------------------|-----|-----|------|------|------|-----|-----|-----|----------|----------------|--------|--------|-----|----|
| KTFC-SCN1915-200M | 1.9 | 1.5 | 0.7 | 17 | 3.5 | 1 | 6 | NPO | 20pF | M (±20%) | 100VDC | 300VDC | 7A | C |
| KTFC-SCN1915-140M | 1.9 | 1.5 | 0.7 | 17 | 3.5 | 1 | 6 | NPO | 14pF | M (±20%) | 100VDC | 300VDC | 7A | C |
| KTFC-SCN1915-100Z | 1.9 | 1.5 | 0.75 | 8.7 | 3 | 1 | 3 | NPO | 10pF | Z (-20%, +80%) | 100VDC | 300VDC | 7A | C |
| KTFC-SCX1915-152Z | 1.9 | 1.5 | 0.6 | 22 | 3.5 | 1 | 10 | X7R | 1500pF | Z (-20%, +80%) | 100VDC | 300VDC | 5A | C |
| KTFC-SCX1915-102Z | 1.9 | 1.5 | 0.6 | 22 | 3.5 | 1 | 10 | X7R | 1000pF | Z (-20%, +80%) | 100VDC | 300VDC | 5A | C |
| KTFC-SCN1915-100Z | 1.9 | 1.5 | 0.6 | 22 | 3.5 | 1 | 10 | NPO | 10pF | Z (-20%, +80%) | 100VDC | 300VDC | 7A | C |
| KTFC-SPIY2222--802*2Z | 2.2 | 2.2 | 0.75 | 28.3 | 12.6 | 0 | 6.5 | Y5V | 8000pF*2 | Z (-20%, +80%) | 100VDC | 300VDC | 7A | PI |
| KTFC-SCY2416-102Z | 2.4 | 1.6 | 0.7 | 30.3 | 4 | 1.5 | 9 | Y5V | 1000pF | Z (-20%, +80%) | 100VDC | 300VDC | 7A | C |
| KTFC-SCY2416-103Z | 2.4 | 1.6 | 0.75 | 30.3 | 4.6 | 1.5 | 9.5 | Y5V | 0.01uF | Z (-20%, +80%) | 100VDC | 300VDC | 10A | C |
| KTFC-SCY2416-472Z | 2.4 | 1.6 | 0.7 | 30.3 | 4 | 1.5 | 9 | Y5V | 4700pF | Z (-20%, +80%) | 100VDC | 300VDC | 7A | C |
| KTFC-SCX2416-102Z | 2.4 | 1.6 | 0.75 | 30.3 | 4 | 1.5 | 9 | X7R | 1000pF | Z (-20%, +80%) | 50VDC | 150VDC | 7A | C |
| KTFC-SCX2416-152Z | 2.4 | 1.6 | 0.75 | 30.3 | 4 | 1.5 | 9 | X7R | 1500pF | Z (-20%, +80%) | 100VDC | 300VDC | 7A | C |
| KTFC-SCS2416-101M | 2.4 | 1.6 | 0.7 | 30.3 | 4 | 1.5 | 9 | SL | 100pF | M (±20%) | 100VDC | 300VDC | 7A | C |
| KTFC-SCY2416-561Z | 2.4 | 1.6 | 0.75 | 30.3 | 4 | 1.5 | 9 | Y5P | 560pF | Z (-20%, +80%) | 100VDC | 300VDC | 7A | C |
| KTFC-SCY2416-222Z | 2.4 | 1.6 | 0.7 | 30.3 | 4 | 1.5 | 9 | Y5U | 2200pF | Z (-20%, +80%) | 100VDC | 300VDC | 7A | C |
| KTFC-SCY2416-332Z | 2.4 | 1.6 | 0.7 | 30.3 | 4 | 1.5 | 9 | Y5V | 3300pF | Z (-20%, +80%) | 50VDC | 150VDC | 7A | C |

| | | | | | | | | | | | | | | |
|-----------------------------|-----|-----|------|------|------|-----|-----|-----|----------|----------------|--------|--------|----|----|
| KTFC-SCN2416-150Z | 2.4 | 1.6 | 0.7 | 30.3 | 4 | 1.5 | 9 | NPO | 15pF | Z (-20%, +80%) | 50VDC | 150VDC | 7A | C |
| KTFC-SCX2416-152Z | 2.4 | 1.6 | 0.75 | 30.3 | 4 | 1.5 | 9 | X7R | 1500pF | Z (-20%, +80%) | 100VDC | 300VDC | 7A | C |
| KTFC-SCN2416-100M | 2.4 | 1.6 | 0.7 | 30.3 | 3 | 1.1 | 9 | NPO | 10pF | M (\pm 20%) | 50VDC | 150VDC | 7A | C |
| KTFC-SCX2424-332Z | 2.4 | 2.4 | 0.75 | 22 | 5 | 0 | 9.5 | X7R | 3300pF | Z (-20%, +80%) | 100VDC | 300VDC | 7A | C |
| KTFC-SLCX2424-332Z | 2.4 | 2.4 | 0.75 | 22 | 5 | 0 | 9.5 | X7R | 3300pF | Z (-20%, +80%) | 100VDC | 300VDC | 7A | LC |
| KTFC-SPiX2525-102*2Z | 2.5 | 2.5 | 0.75 | 28.3 | 10.3 | 0 | 7.5 | X7R | 1000pF*2 | Z (-20%, +80%) | 100VDC | 300VDC | 7A | PI |
| KTFC-SCX2618-332Z | 2.6 | 1.8 | 0.75 | 30.3 | 3.5 | 1 | 9.5 | X7R | 1000pF | Z (-20%, +80%) | 100VDC | 300VDC | 7A | C |
| KTFC-SCS2618-800Z | 2.6 | 1.8 | 0.7 | 30.3 | 3.5 | 1 | 9.5 | SL | 80pF | Z (-20%, +80%) | 100VDC | 300VDC | 7A | C |
| KTFC-SCY2618-471Z | 2.6 | 1.8 | 0.75 | 30.3 | 3.5 | 1 | 9.5 | Y5P | 470pF | Z (-20%, +80%) | 100VDC | 300VDC | 7A | C |
| KTFC-SCY2618-222Z | 2.6 | 1.8 | 0.7 | 30.3 | 3.5 | 1 | 9.5 | Y5U | 2200pF | Z (-20%, +80%) | 100VDC | 300VDC | 7A | C |
| KTFC-SCY2618-332Z | 2.6 | 1.8 | 0.75 | 22 | 3.5 | 1 | 9.5 | Y5V | 3300pF | Z (-20%, +80%) | 100VDC | 300VDC | 7A | C |
| KTFC-SCN2618-100Z | 2.6 | 1.8 | 0.75 | 22 | 3.5 | 1 | 9.5 | NPO | 10pF | Z (-20%, +80%) | 100VDC | 300VDC | 7A | C |
| KTFC-SCX2618-102Z | 2.6 | 1.8 | 0.75 | 22 | 3.5 | 1 | 9.5 | X7R | 1000pF | Z (-20%, +80%) | 100VDC | 300VDC | 7A | C |
| KTFC-SCX2618-152Z | 2.6 | 1.8 | 0.75 | 22 | 3.5 | 1 | 9.5 | X7R | 1500pF | Z (-20%, +80%) | 100VDC | 300VDC | 7A | C |
| KTFC-SCX2618-102Z | 2.6 | 1.8 | 0.75 | 22 | 3.5 | 1 | 9.5 | X7R | 1000pF | Z (-20%, +80%) | 100VDC | 300VDC | 7A | C |
| KTFC-SCY2618-471Z | 2.6 | 1.8 | 0.75 | 6 | 3.5 | 1 | 1 | Y5P | 470pF | Z (-20%, +80%) | 100VDC | 300VDC | 7A | C |

| | | | | | | | | | | | | | | |
|--------------------------|-----|-----|------|------|-----|-----|-----|-----|--------|------------------|--------|--------|----|---|
| KTFC-SCS2618-470P | 2.6 | 1.8 | 0.7 | 30.3 | 3.5 | 1 | 9.5 | SL | 47pF | P (-0%, +100%) | 100VDC | 300VDC | 7A | C |
| KTFC-SCS2618-800Z | 2.6 | 1.8 | 0.5 | 14.5 | 3.5 | 1 | 5 | SL | 80pF | Z (-20%, +80%) | 100VDC | 300VDC | 5A | C |
| KTFC-SCX2618-102Z | 2.6 | 1.8 | 0.5 | 14.5 | 3.5 | 1 | 5 | X7R | 1000pF | Z (-20%, +80%) | 100VDC | 300VDC | 5A | C |
| KTFC-SCN2618-100Z | 2.6 | 1.8 | 0.7 | 30.3 | 3.5 | 1 | 9.5 | NPO | 10pF | Z (-20%, +80%) | 100VDC | 300VDC | 7A | C |
| KTFC-SCN2618-100Z | 2.6 | 1.8 | 0.7 | 30.3 | 3.5 | 1 | 9.5 | NPO | 10pF | Z (-20%, +80%) | 200VDC | 500VDC | 7A | C |
| KTFC-SCX2618-152Z | 2.6 | 1.8 | 0.56 | 22 | 3.5 | 1 | 10 | X7R | 1500pF | Z (-20%, +80%) | 100VDC | 300VDC | 7A | C |
| KTFC-SCX2618-102Z | 2.6 | 1.8 | 0.75 | 22 | 3.5 | 1 | 9.5 | X7R | 1000pF | Z (-20%, +80%) | 100VDC | 300VDC | 7A | C |
| KTFC-SCS2618-101Z | 2.6 | 1.8 | 0.75 | 22 | 3.5 | 1 | 9.5 | SL | 100pF | Z (-20%, +80%) | 100VDC | 300VDC | 7A | C |
| KTFC-SCK2618-500Z | 2.6 | 1.8 | 0.7 | 30.3 | 3.5 | 1 | 9.5 | KL | 50pF | Z (-20%, +80%) | 100VDC | 300VDC | 7A | C |
| KTFC-SCY2618-471Z | 2.6 | 1.8 | 0.75 | 30.3 | 3.5 | 1 | 9.5 | Y5P | 470pF | Z (-20%, +80%) | 100VDC | 300VDC | 7A | C |
| KTFC-SCS2618-101Z | 2.6 | 1.8 | 0.75 | 22 | 3.5 | 1 | 9.5 | SL | 100pF | Z (-20%, +80%) | 100VDC | 300VDC | 7A | C |
| KTFC-SCS2618-050Z | 2.6 | 1.8 | 0.75 | 22 | 3.5 | 1 | 9.5 | SL | 5pF | Z (-20%, +80%) | 100VDC | 300VDC | 7A | C |
| KTFC-SCX3822-102Z | 3.8 | 2.2 | 0.75 | 19 | 4.5 | 1.5 | 9.5 | X7R | 1000pF | Z (-20%, +80%) | 100VDC | 300VDC | 7A | C |
| KTFC-SCX3822-152K | 3.8 | 2.2 | 0.75 | 19 | 4.5 | 1.5 | 9.5 | X7R | 1500pF | K ($\pm 10\%$) | 100VDC | 300VDC | 7A | C |
| KTFC-SCS3822-800Z | 3.8 | 2.2 | 0.75 | 19 | 4.5 | 1.5 | 9.5 | SL | 80pF | Z (-20%, +80%) | 100VDC | 300VDC | 7A | C |
| KTFC-SCY3822-471Z | 3.8 | 2.2 | 0.75 | 19 | 4.5 | 1.5 | 9.5 | Y5P | 470pF | Z (-20%, +80%) | 100VDC | 300VDC | 7A | C |

| | | | | | | | | | | | | | | |
|--------------------|-----|-----|------|------|-----|-----|------|-----|---------|------------------|--------|--------|----|---|
| KTFC-SCY3822-202Z | 3.8 | 2.2 | 0.75 | 30.3 | 4.5 | 2.5 | 9.5 | Y5U | 2000pF | Z (-20%, +80%) | 50VDC | 150VDC | 7A | C |
| KTFC-SCY3822-332Z | 3.8 | 2.2 | 0.75 | 19 | 4.5 | 1.5 | 9.5 | Y5V | 3300pF | Z (-20%, +80%) | 100VDC | 300VDC | 7A | C |
| KTFC-SCN3822--100Z | 3.8 | 2.2 | 0.75 | 19 | 4.5 | 1.5 | 9.5 | NPO | 10pF | Z (-20%, +80%) | 100VDC | 300VDC | 7A | C |
| KTFC-SCY3822-202Z | 3.8 | 2.2 | 0.75 | 57 | 6.5 | 2 | 23 | Y5U | 2000pF | Z (-20%, +80%) | 100VDC | 300VDC | 7A | C |
| KTFC-SCX3822-102Z | 3.8 | 2.2 | 0.75 | 22 | 4.5 | 1.5 | 9.5 | X7R | 1000pF | Z (-20%, +80%) | 100VDC | 300VDC | 7A | C |
| KTFC-SCX3822-102Z | 3.8 | 2.2 | 0.75 | 30.3 | 4.5 | 1.5 | 9.5 | X7R | 1000pF | Z (-20%, +80%) | 100VDC | 300VDC | 7A | C |
| KTFC-SCX3822B-102Z | 3.8 | 2.2 | 0.75 | 57 | 4.5 | 1.5 | 23 | X7R | 1000pF | Z (-20%, +80%) | 100VDC | 300VDC | 7A | C |
| KTFC-SCX3822-102Z | 3.8 | 2.2 | 0.75 | 57 | 6.5 | 2 | 23 | X7R | 1000pF | Z (-20%, +80%) | 100VDC | 300VDC | 7A | C |
| KTFC-SCX3822-102Z | 3.8 | 2.2 | 0.75 | 19 | 5 | 1.5 | 9.5 | X7R | 1000pF | Z (-20%, +80%) | 100VDC | 300VDC | 7A | C |
| KTFC-SCX3822-152K | 3.8 | 2.2 | 0.75 | 19 | 5 | 1.5 | 9.5 | X7R | 1500pF | K ($\pm 10\%$) | 100VDC | 300VDC | 7A | C |
| KTFC-SCY3822-682Z | 3.8 | 2.2 | 0.75 | 28.2 | 6 | 1.5 | 12.5 | Y5V | 6800 pF | Z (-20%, +80%) | 100VDC | 300VDC | 7A | C |
| KTFC-SCS3822-470Z | 3.8 | 2.2 | 0.75 | 57 | 6.5 | 2 | 23 | SL | 47pF | Z (-20%, +80%) | 100VDC | 300VDC | 7A | C |
| KTFC-SCY3822-202Z | 3.8 | 2.2 | 0.75 | 30.3 | 4.5 | 1.5 | 9.5 | Y5U | 2000pF | Z (-20%, +80%) | 50VDC | 150VDC | 7A | C |
| KTFC-SCY3822--202Z | 3.8 | 2.2 | 0.75 | 30.3 | 4.5 | 1.5 | 9.5 | Y5U | 2000pF | Z (-20%, +80%) | 100VDC | 300VDC | 7A | C |
| KTFC-SCX3822-122K | 3.8 | 2.2 | 0.6 | 22 | 4.5 | 1.5 | 9.5 | X7R | 1200pF | K ($\pm 10\%$) | 100VDC | 300VDC | 5A | C |
| KTFC-SCY3822-332Z | 3.8 | 2.2 | 0.75 | 30.3 | 6 | 2.5 | 9.5 | Y5V | 3300pF | Z (-20%, +80%) | 100VDC | 300VDC | 7A | C |

| | | | | | | | | | | | | | | |
|--------------------------|-----|-----|------|------|-----|-----|----|-----|--------|----------------|--------|--------|-----|---|
| KTFC-SCX4020-102Z | 4 | 2 | 0.75 | 19 | 2.5 | 1.2 | 9 | X7R | 1000pF | Z (-20%, +80%) | 100VDC | 300VDC | 7A | C |
| KTFC-SCX4224-102Z | 4.2 | 2.4 | 1 | 28.3 | 3 | 1 | 13 | X7R | 1000pF | Z (-20%, +80%) | 100VDC | 300VDC | 10A | C |
| KTFC-SCS4224-102Z | 4.2 | 2.4 | 1 | 28.3 | 3 | 1 | 13 | SL | 100pF | Z (-20%, +80%) | 100VDC | 300VDC | 10A | C |
| KTFC-SCY4224-471Z | 4.2 | 2.4 | 1 | 28.3 | 3 | 1 | 13 | Y5P | 470pF | Z (-20%, +80%) | 100VDC | 300VDC | 10A | C |
| KTFC-SCY4224-222Z | 4.2 | 2.4 | 1 | 28.3 | 3 | 1 | 13 | Y5U | 2200pF | Z (-20%, +80%) | 100VDC | 300VDC | 10A | C |
| KTFC-SCY4224-332Z | 4.2 | 2.4 | 1 | 28.3 | 3 | 1 | 13 | Y5V | 3300pF | Z (-20%, +80%) | 100VDC | 300VDC | 10A | C |
| KTFC-SCN4224-100Z | 4.2 | 2.4 | 1 | 28.3 | 3 | 1 | 13 | NPO | 10pF | Z (-20%, +80%) | 100VDC | 300VDC | 10A | C |
| KTFC-SCX4330-102M | 4.3 | 3 | 1 | 28.3 | 2.7 | 1.2 | 13 | X7R | 1000pF | M (\pm 20%) | 100VDC | 300VDC | 10A | C |
| KTFC-SCY4330-471Z | 4.3 | 3 | 1 | 28.3 | 2.7 | 1.2 | 13 | Y5P | 470pF | Z (-20%, +80%) | 100VDC | 300VDC | 10A | C |
| KTFC-SCY4330-331Z | 4.3 | 3 | 1 | 28.3 | 2.7 | 1.2 | 13 | Y5P | 330pF | Z (-20%, +80%) | 100VDC | 300VDC | 10A | C |
| KTFC-SCX4532-102Z | 4.5 | 3.2 | 0.7 | 24 | 6 | 2.5 | 10 | X7R | 1000pF | Z (-20%, +80%) | 400VDC | 800VDC | 6A | C |
| KTFC-SCX4532-102Z | 4.5 | 3.2 | 0.7 | 24 | 6 | 2.5 | 10 | X7R | 1000pF | Z (-20%, +80%) | 50VAC | 500VAC | 6A | C |
| KTFC-SCX4532-102Z | 4.5 | 3.2 | 0.7 | 24 | 6 | 2.5 | 10 | X7R | 1000pF | Z (-20%, +80%) | 100VDC | 300VDC | 6A | C |
| KTFC-SCX4532-102Z | 4.5 | 3.2 | 0.7 | 24 | 6 | 2.5 | 10 | X7R | 1000pF | Z (-20%, +80%) | 100VAC | 500VAC | 6A | C |
| KTFC-SCX4532-102Z | 4.5 | 3.2 | 0.7 | 24 | 6 | 2.5 | 10 | X7R | 1000pF | Z (-20%, +80%) | 500VDC | 750VDC | 6A | C |
| KTFC-SCX4532-102Z | 4.5 | 3.2 | 1 | 28.3 | 6 | 2.1 | 12 | X7R | 1000pF | Z (-20%, +80%) | 100VAC | 500VAC | 10A | C |

| | | | | | | | | | | | | | | |
|---------------------------|-----|-----|------|------|-----|-----|-----|-----|--------|----------------|--------|--------|-----|---|
| KTFC-SCX4532-102Z | 4.5 | 3.2 | 1 | 28.3 | 6 | 2.1 | 12 | X7R | 1000pF | Z (-20%, +80%) | 220VAC | 500VAC | 10A | C |
| KTFC-SCX4532-102Z | 4.5 | 3.2 | 1.2 | 35 | 5.6 | 2.1 | 14 | X7R | 1000pF | Z (-20%, +80%) | 250VAC | 650VAC | 15A | C |
| KTFC-SCX4532-102Z | 4.5 | 3.2 | 0.75 | 57 | 6 | 2.1 | 22 | X7R | 2200pF | Z (-20%, +80%) | 400VDC | 800VDC | 7A | C |
| KTFC-SCX4722-102Z | 4.7 | 2.2 | 0.8 | 22 | 3.2 | 1 | 12 | X7R | 1000pF | Z (-20%, +80%) | 100VDC | 300VDC | 7A | C |
| KTFC-SCX4722-821Z | 4.7 | 2.2 | 0.8 | 22 | 3.2 | 1 | 12 | X7R | 820pF | Z (-20%, +80%) | 100VDC | 300VDC | 7A | C |
| KTFC-SCX4722-102Z | 4.7 | 2.2 | 0.75 | 22 | 3.2 | 1 | 12 | X7R | 1000pF | Z (-20%, +80%) | 200VDC | 500VDC | 7A | C |
| KTFC-SCX4722-102Z | 4.7 | 2.2 | 0.75 | 22 | 3.2 | 1 | 12 | X7R | 1000pF | Z (-20%, +80%) | 100VDC | 300VDC | 7A | C |
| KTFC-SCY4722-332Z | 4.7 | 2.2 | 0.75 | 22 | 3.2 | 1 | 12 | Y5V | 3300pF | Z (-20%, +80%) | 100VDC | 300VDC | 7A | C |
| KTFC-SCX4722-222Z | 4.7 | 2.2 | 1 | 28.3 | 4 | 1.5 | 13 | X7R | 2200pF | Z (-20%, +80%) | 100VDC | 300VDC | 10A | C |
| KTFC-SCS4722-101Z | 4.7 | 2.2 | 0.75 | 22 | 3.2 | 1 | 12 | SL | 100pF | Z (-20%, +80%) | 100VDC | 300VDC | 7A | C |
| KTFC-SCY4722-472Z | 4.7 | 2.2 | 0.7 | 22 | 3.2 | 1 | 12 | Y5V | 4700pF | Z (-20%, +80%) | 100VDC | 300VDC | 7A | C |
| KTFC-SCY4722-472Z | 4.7 | 2.2 | 0.7 | 30.3 | 3.2 | 1 | 9.5 | Y5V | 4700pF | Z (-20%, +80%) | 100VDC | 300VDC | 7A | C |
| KTFC-SCX4722-102Z | 4.7 | 2.2 | 0.7 | 24 | 3.2 | 1 | 10 | X7R | 1000pF | Z (-20%, +80%) | 100VDC | 300VDC | 7A | C |
| KTFC-SCY4722-222Z | 4.7 | 2.2 | 0.75 | 22 | 3.2 | 1 | 12 | Y5V | 2200pF | Z (-20%, +80%) | 100VDC | 300VDC | 7A | C |
| KTFC-SCX4722-102Z | 4.7 | 2.2 | 0.75 | 22 | 3.2 | 1 | 12 | X7R | 1000pF | Z (-20%, +80%) | 100VDC | 300VDC | 7A | C |
| KTFC-SCX4722B-102Z | 4.7 | 2.2 | 0.75 | 30.3 | 3.2 | 1 | 9.5 | X7R | 1000pF | Z (-20%, +80%) | 100VDC | 300VDC | 7A | C |

| | | | | | | | | | | | | | | |
|---------------------------|-----|-----|------|------|-----|-----|------|-----|--------|------------------|--------|--------|-----|---|
| KTFC-SCY4722-472Z | 4.7 | 2.2 | 0.7 | 24 | 3.2 | 1 | 12 | Y5V | 4700pF | Z (-20%, +80%) | 100VDC | 300VDC | 7A | C |
| KTFC-SCY4722-102Z | 4.7 | 2.2 | 0.75 | 22 | 3.2 | 1 | 12 | X7R | 1000pF | Z (-20%, +80%) | 100VDC | 300VDC | 7A | C |
| KTFC-SCX4737--102Z | 4.7 | 3.7 | 1.5 | 35 | 6.5 | 2.1 | 12 | X7R | 1000pF | Z (-20%, +80%) | 100VAC | 500VAC | 20A | C |
| KTFC-SCY4737-472Z | 4.7 | 3.7 | 1.5 | 35 | 6.5 | 2.1 | 12 | Y5V | 4700pF | Z (-20%, +80%) | 100VDC | 300VDC | 20A | C |
| KTFC-SCY5034-472Z | 5 | 3.4 | 1.5 | 35 | 4 | 1.5 | 13 | Y5V | 4700pF | Z (-20%, +80%) | 100VDC | 300VDC | 20A | C |
| KTFC-SCX5038-102M | 5 | 3.8 | 0.75 | 30.3 | 4.1 | 2 | 9 | X7R | 1000pF | M ($\pm 20\%$) | 100VDC | 300VDC | 7A | C |
| KTFC-SCX5122-202Z | 5.1 | 2.2 | 0.8 | 28.3 | 4.5 | 1.5 | 12.5 | X7R | 2000pF | Z (-20%, +80%) | 50VDC | 150VDC | 7A | C |
| KTFC-SCX5122-332Z | 5.1 | 2.2 | 0.8 | 28.3 | 6 | 2.5 | 11.5 | X7R | 3300pF | Z (-20%, +80%) | 200VDC | 600VDC | 7A | C |
| KTFC-SCX5122-202Z | 5.1 | 2.2 | 1 | 28.3 | 4.5 | 1.5 | 12.5 | X7R | 2000pF | Z (-20%, +80%) | 50VDC | 150VDC | 10A | C |
| KTFC-SCX5122-103Z | 5.1 | 2.2 | 1 | 28.3 | 6 | 2.5 | 11.5 | Y5V | 0.01uF | Z (-20%, +80%) | 100VDC | 300VDC | 10A | C |
| KTFC-SCX5122-332Z | 5.1 | 2.2 | 1 | 28.3 | 6 | 2.5 | 11.5 | X7R | 3300pF | Z (-20%, +80%) | 100VDC | 300VDC | 10A | C |
| KTFC-SCX5124--332Z | 5.1 | 2.4 | 1 | 28.3 | 6 | 1.5 | 12.5 | X7R | 3300pF | Z (-20%, +80%) | 100VDC | 300VDC | 10A | C |