

Drop-in Circulators

Part Number: KTDC-2002

Key Features

- Frequency Range: 18.0GHz-24.5GHz
- Low Insertion Loss, High Isolation,
- Small Size, High Performance
- Wide Operating Temperature Range : -40°C~+70°C
- Commercial, Military and Space Applications

Electrical Specifications at Room (25°C±5°C) Temperature

Part Number	Freq. Range (GHz)	Bandwidth Max. (MHz)	Insertion Loss Max. (dB)	Isolation Min. (dB)	VSWR Max.	Forward Power (W)	Connector Type
KTDC-2002	18.0 - 24.5	2000	0.6	18	1.35	10	TAB

Mechanical Dimensions (mm)

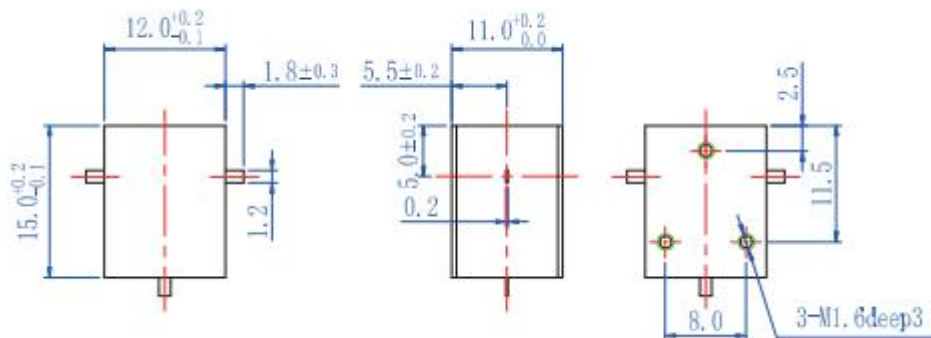

HOW TO ORDER

